

FUSIBILI SPECIALI

SPECIAL FUSES | FUSIBLES SPECIAUX



PARTNERS



FUSIBILI 10X85 E 14X51PV pag. 73

10x38 and 10x85 PV
Fusibles 10x85 PV

FUSIBILI NH1-NH2-NH3 SOLAR 1100VDC pag. 76

1100Vdc NH1-NH2-NH3 SOLAR fuses
Fusibles NH1-NH2-NH3 SOLAR 1100Vdc

FUSIBILI NH1-NH2-NH3 SOLAR 1500VDC pag. 76

1500Vdc NH1-NH2-NH3 SOLAR fuses
Fusibles NH1-NH2-NH3 SOLAR 1500Vdc

BASI UNIPOLARI NH METALLICHE 1500VDC pag. 77

1500Vdc NH single-pole metal bases
Bases Unipolaires NH métalliques 1500Vdc



INDICE Index | *Index*
FUSIBILI 10x38 e 10x85 PV SOLAR

 10x38 and 10x85 PV SOLAR fuses | *Fusibles 10x38 et 10x85 PV SOLAR*

FUSIBILI E PORTAFUSIBILI 14X51 SOLAR

 14X51 SOLAR fuse and fuse-holders | *Fusibles et porte-fusibles 14x51 SOLAR*

FUSIBILI NH0-NH1 SOLAR 750Vdc 1000Vdc 1100Vdc 1500Vdc

 750Vdc 1000Vdc 1100Vdc 1500Vdc NH0-NH1 SOLAR fuses | *Fusibles NH0-NH1 SOLAR 750Vdc 1000Vdc 1100Vdc 1500Vdc*

FUSIBILI PER PROTEZIONE BATTERIE

 Fuses for battery protection | *Fusibles pour la protection des batteries*

BASE UNIPOLARI NH 1000Vdc 1200Vdc 1500Vdc SOLAR

 1000Vdc 1200Vdc 1500Vdc NH unipolar base | *Bases unipolaires NH 1000Vdc 1200Vdc 1500Vdc*

FUSIBILI PVS-R SOLAR

 PVS-R SOLAR fuses | *Fusibles PVS-R SOLAR*

BASE PORTAFUSIBILI CLASSE R 600VDC SOLAR

 600Vdc class R Solar fuse block | *Bases porte-fusibles Classe R 600Vdc Solar*

ACCESSORI

 Accessories | *Accessoires*

APPLICAZIONI Applications | *Applications*

- **Impianti solari**
Solar plants
Installations solaires
- **UPS**
UPS system
Onduleurs
- **Sistemi di stoccaggio a batterie**
Battery storage system
Systèmes de stockage à batteries

VANTAGGI Advantages | *Avantages*

- **Omologazioni UL**
UL approvals
Homologations UL
- **Ampia gamma**
Wide range
Large gamme
- **Ottima performance in D.C.**
Excellent performance under D.C.
Performance optimale en D.C.

FOTOVOLTAICO

Photovoltaic | Photovoltaïque



FUSIBILI 10X38 E 10X85 SOLAR PV

10x38 and 10x85 PV SOLAR fuses | Fusibles 10x38 et 10x85 PV SOLAR

Caratteristica	Characteristic	Caractéristique
gPV	gPV	gPV
Tensione	Voltage	Tension
1000Vdc (10x38)	1000Vdc (10x38)	1000Vdc (10x38)
1500Vdc (10x85)	1500Vdc (10x85)	1500Vdc (10x85)
Corpo	Body	Corps
Ceramica	Ceramic	Céramique
Capacità di rottura	Breaking capacity	Pouvoir de coupure
10kAdc - 40kAdc (10x38)	10kAdc - 40kAdc (10x38)	10kAdc - 40kAdc (10x38)
30kAdc (10x85)	30kAdc (10x85)	30kAdc (10x85)
Norme riferimento	Standards	Normes
UL 248-1	UL 248-1	UL 248-1
IEC 60269 - UL 2579	IEC 60269 - UL 2579	IEC 60269 - UL 2579
IEC 60269-6 ed 1.0	IEC 60269-6 ed 1.0	IEC 60269-6 ed 1.0
Cod. omologazione	Approval code	Code d'homologation
Bussmann: PVxxA10F(10x38)	Bussmann: PVxxA10F(10x38)	Bussmann: PVxxA10F(10x38)
ETI: 10x85gpv (10x85)	ETI: 10x85gpv (10x85)	ETI: 10x85gpv (10x85)

pag. 84-86



Corrente nominale	Codice	Capacità di rottura	Pt (A ² s)	Pot. dissipata
Rated current	Code	Breaking capacity	Pt (A ² s)	Power loss
Courant nominal	Code	Pouvoir de coupure	Pt (A ² s)	Puissance dissipée
10x38				
	UL	IEC		
1 A	FF138210/DC	10 kAdc	40 kAdc	0,4 1,5 W
2 A	FF138220/DC	10 kAdc	40 kAdc	3,4 1,0 W
3 A	FF138230/DC	10 kAdc	40 kAdc	11 1,3 W
4 A	FF138240/DC	10 kAdc	40 kAdc	26 1,5 W
5 A	FF138250/DC	10 kAdc	40 kAdc	50 1,6 W
6 A	FF138260/DC	10 kAdc	40 kAdc	90 1,8 W
8 A	FF138280/DC	10 kAdc	33 kAdc	32 2,1 W
10 A	FF138310/DC	10 kAdc	33 kAdc	70 2,3 W
12 A	FF138312/DC	10 kAdc	33 kAdc	120 2,7 W
15 A	FF138315/DC	10 kAdc	33 kAdc	220 2,9 W
*20 A	FF138320/DC	-	10 kAdc	350 3,6 W
10x85				
	UL	IEC		
4 A	FF185240/DC	10kAdc	30 kAdc	15,1 2,7 W NEW
5 A	FF185250/DC	10kAdc	30 kAdc	33,2 3,0 W NEW
6 A	FF185260/DC	10kAdc	30 kAdc	50,4 3,0 W NEW
8 A	FF185280/DC	10kAdc	30 kAdc	109 3,6 W NEW
10 A	FF185310/DC	10kAdc	30 kAdc	191 3,7 W NEW
12 A	FF185312/DC	10kAdc	30 kAdc	118 3,3 W NEW
15 A	FF185315/DC	10kAdc	30 kAdc	161 3,6 W NEW
16 A	FF185316/DC	10kAdc	30 kAdc	164 3,7 W NEW
*20 A	FF185320/DC	10kAdc	30 kAdc	209 4,0 W NEW
*25 A	FF185325/DC	10kAdc	30 kAdc	504 5,2 W NEW



• Non omologato
Not approved
Non homologué



* 10X85
20A-25A = 1200Vdc



Su richiesta fornibili con contatti a bullone - da C.S. 1 o 2 pin
Bolt contacts or for PCB or with 2 pins upon request
Fournissable sur demande avec des contacts à boulon - de C.I. 1 ou 2 pin



10 pz
10 pcs
10 pces



30 giorni
30 days
30 jours



PORTAFUSIBILI 10X38

10x38 fuseblock | Porte-fusibles 10x38 PV SOLAR

Corrente	Current	Courant
25A	25A	25A
Tensione	Voltage	Tension
1000Vdc	1000Vdc	1000Vdc
Categoria	Category	Catégorie
DC - 20B	DC - 20B	DC - 20B
Corpo	Body	Corps
Nylon UL94-V0 autoestinguente	Nylon UL94-V0 self-extinguishing	Nylon UL94-V0 auto-extinguible
Contatti	Contacts	Contacts
Rame argentato	Silver plated copper	Cuivre argenté
Norme riferimento	Standards	Normes
IEC 60947-1, IEC 60947-3, UL 248-1, UL 4248-18, UL 486E, CSA C22.2 NO.65	IEC 60947-1, IEC 60947-3, UL 4248-1, UL 4248-18, UL 486E, CSA C22.2 NO.65	IEC 60947-1, IEC 60947-3, UL 4248-1, UL 4248-18, UL 486E, CSA C22.2 NO.65
Cod. omologazione	Approval code	Code d'homologation
ETI: PCF DC (QE) EFH (QH)	ETI: PCF DC (QE) EFH (QH)	ETI: PCF DC (QE) EFH (QH)



N°Poli	Codice	Peso g	Dimensione B	
N°Poles	Code	Weight g	Dimension B	
N°Pôles	Code	Poids g	Dimension B	
10x38 cassetto estraibile Removable drawer Tirour amovible				
1	QE13801/DC	58	17,8	
2	QE13802/DC	120	35,6	
10x38 con led, cassetto estraibile With led, removable drawer Avec led, tirour amovible				
1	QE13801/L/DC	58	17,8	
2	QE13802/L/DC	120	35,6	
10x38 sezionatore Fuse-switch Sectionneur				
1	QH13801/DC	63	17,5	
2	QH13802/DC	124	35	
10x38 con led, sezionatore With led fuse-switch Avec led, sectionneur				
1	QH13801/L/DC	64	17,5	
2	QH13802/L/DC	125	35	
Accessori Accessories Accessoires				
Codice	Corrente	Diametro	Materiale	Codi. omologazione
Code	Current	Diameter	Material	Approval code
Code	Courant	Diamètre	Matériau	Code d'homologation
Pinze 10X38 Pliers Pinces				
PZ1A340009	20 A	10mm	Bronzo stagnato	BUSS - 1A3400-09
PZ1008	3 A	10mm	Bronzo stagnato	250
Capuccio 10X38 Cap Capuchon				
CP5538			Gomma trasparente autoestinguente	500
Maniglia Handle Poignée				
NH9M001/1100DC per fusibili 1100 Vdc				

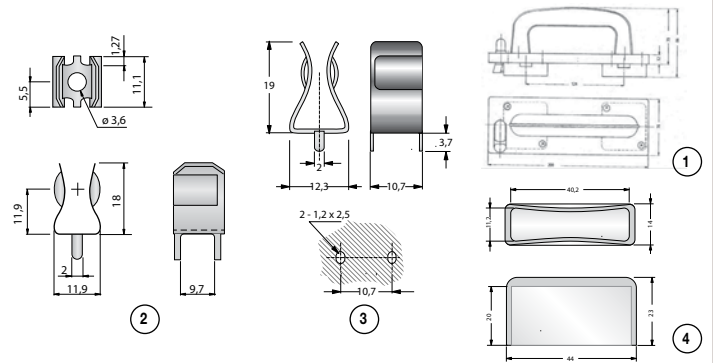

pronta
in stock
en stock



FUSIBILI 14X51

14x51 fuses | Fusibles 14X51

Caratteristica	Characteristic	Caractéristique
gPV	gPV	gPV
Tensione 1000Vdc	Voltage 1000Vdc	Tension 1000Vdc
Corpo Ceramica	Body Ceramic	Corps Céramique
Capacità di rottura 10kAdc	Breaking capacity 10kAdc	Pouvoir de coupure 10kAdc
Norme riferimento IEC 60269-6 ed 1.0	Standards IEC 60269-6 ed 1.0	Normes IEC 60269-6 ed 1.0
Cod. omologazione ETI: 14x51gPV	Approval code ETI: 14x51gPV	Code d'homologation ETI: 14x51gPV



Corrente nominale	Codice	Capacità di rottura	I ² t (A ² s)	Pot. dissipata
Rated current Courant nominal	Code Code	Breaking capacity Pouvoir de coupure	I ² t (A ² s) I ² t (A ² s)	Power loss Puissance dissipée
16 A	FF151316/DC	10 kAdc	155	3,1 W
20 A	FF151320/DC	10 kAdc	330	3,2 W
25 A	FF151325/DC	10 kAdc	360	4 W
36 A	FF151336/DC	10 kAdc	1190	5,6 W



FOTOVOLTAICO

Photovoltaic | Photovoltaïque

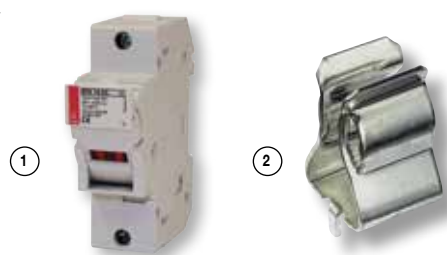

PORTAFUSIBILI 14X51

14x51 fuseblock | Porte-fusibles 14X51

Corrente	Current	Courant
50 A	50 A	50 A
Tensione 1000Vdc	Voltage 1000Vdc	Tension 1000Vdc
Categoria DC - 20B	Category DC - 20B	Catégorie DC - 20B
Corpo Nylon UL94-V0 autoestinguente	Body Nylon UL94-V0 self-extinguishing	Corps Nylon UL94-V0 auto-extinguible
Contatti Rame argentato	Contacts Silver plated copper	Contacts Cuirre argenté
Norme di riferimento IEC 60947-1 IEC 60947-3 UL 4248-1 UL 4248-18 UL 486E CSA C22.2 NO.65	Standards IEC 60947-1 IEC 60947-3 UL 4248-1 UL 4248-18 UL 486E CSA C22.2 NO.65	Normes IEC 60947-1 IEC 60947-3 UL 4248-1 UL 4248-18 UL 486E CSA C22.2 NO.65
Cod. omologazione ETI: EFM14dc	Approval code ETI: EFM14dc	Code d'homologation ETI: EFM14dc



N°Poli	Codice	Peso g	Dimensione B	
N°Poles N°Pôles	Code Code	Weight g Poids g	Dimension B Dimension B	
14X51 (1)				
1	QH15101/DC	102	27	12/96
2	QH15102/DC	206	54	6/48
14X51 con led With led Avec led				
1	QH15101/L/DC	103	27	12/96
2	QH15102/L/DC	208	54	6/48

Codice	Corrente	Diametro	Materiale	Codi. omologazione	
Code Code	Current Courant	Diameter Diamètre	Material Matériau	Approval code Code d'homologation	
Pinze 14X51 (2) Pliers Pinces					
PZ559152		14mm	Bronzo stagnato	BUSS - 5591 - 52	100



FOTOVOLTAICO

Photovoltaic | Photovoltaïque

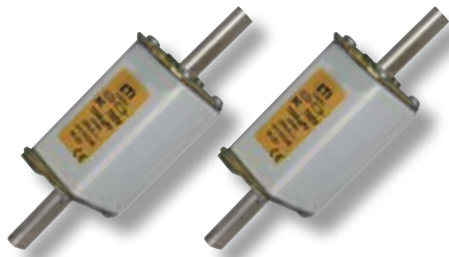

FUSIBILI NH0-NH1 SOLAR 750VDC

750Vdc NH0-NH1 SOLAR fuses | Fusibles NH0-NH1 SOLAR 750Vdc

Caratteristica gPV	Characteristic gPV	Caractéristique gPV
Tensione 750Vdc	Voltage 750Vdc	Tension 750Vdc
Capacità di rottura 20kAdc	Breaking capacity 20kAdc	Pouvoir de coupure 20kAdc
Norme riferimento IEC 60269 - 6 ED 1.0 IEC 60269 - 4	Standards IEC 60269 - 6 ED 1.0 IEC 60269 - 4	Normes IEC 60269 - 6 ED 1.0 IEC 60269 - 4

pag. 84-86



Corrente nominale Rated current Courant nominal	Codice Code Code	I ² t (A ² s) I ² t (A ² s) I ² t (A ² s)	Pot. dissipata Power loss Puissance dissipée	Peso g Weight g Poids g
NH0				
32 A	NH0G032/750DC	370	7,6 W	280
40 A	NH0G040/750DC	650	8,8 W	280
50 A	NH0G050/750DC	1000	11,0 W	280
63 A	NH0G063/750DC	1790	13,5 W	280
80 A	NH0G080/750DC	3000	17,0 W	280
100 A	NH0G100/750DC	6140	21,0 W	280
125 A	NH0G125/750DC	14090	22 W	280
160 A	NH0G160/750DC	27220	32 W	280
NH1				
32 A	NH1G032/750DC	370	7,6 W	300
40 A	NH1G040/750DC	650	8,8 W	300
50 A	NH1G050/750DC	1000	11,0 W	300
63 A	NH1G063/750DC	1790	13,5 W	300
80 A	NH1G080/750DC	3000	17,0 W	300
100 A	NH1G100/750DC	6140	21,0 W	300
125 A	NH1G125/750DC	14090	22 W	300
160 A	NH1G160/750DC	27220	32 W	300

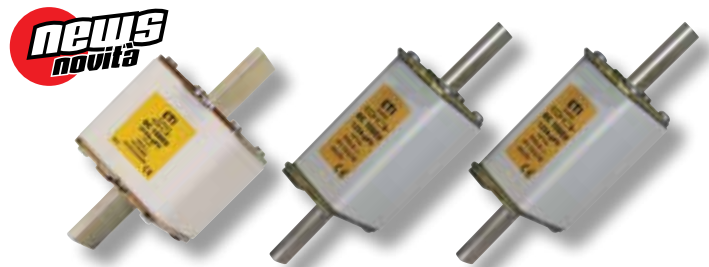

FUSIBILI NH0-NH1-NH3 SOLAR 1000VDC

1000Vdc NH0-NH1-NH3 SOLAR fuses | Fusibles NH0-NH1-NH3 SOLAR 1000Vdc

Caratteristica gPV	Characteristic gPV	Caractéristique gPV
Tensione 1000Vdc	Voltage 1000Vdc	Tension 1000Vdc
Capacità di rottura 20kAdc 10kAdc (NH3)	Breaking capacity 20kAdc 10kAdc (NH3)	Pouvoir de coupure 20kAdc 10kAdc (NH3)
Norme riferimento IEC 60269 - 6 ED 1.0	Standards IEC 60269 - 6 ED 1.0	Normes IEC 60269 - 6 ED 1.0

pag. 84-86



Corrente nominale Rated current Courant nominal	Codice Code Code	Tensione nominale Rated voltage Tension nominale	I ² t (A ² s) I ² t (A ² s) I ² t (A ² s)	Pot. dissipata Power loss Puissance dissipée	Peso g Weight g Poids g
NH0					
32 A	NH0G032/1000DC	1000 Vdc	430	7,6 W	280
40 A	NH0G040/1000DC	1000 Vdc	730	8,8 W	280
50 A	NH0G050/1000DC	1000 Vdc	920	11,0 W	280
63 A	NH0G063/1000DC	1000 Vdc	1760	13,5 W	280
80 A	NH0G080/1000DC	1000 Vdc	3160	17,0 W	280
100 A	NH0G100/1000DC	1000 Vdc	5280	21,0 W	280
125 A	NH0G125/1000DC	1000 Vdc	11340	22 W	280
160 A	NH0G160/900DC	1000 Vdc	20750	32 W	280
NH1					
32 A	NH1G032/1000DC	1000 Vdc	430	7,6 W	300
40 A	NH1G040/1000DC	1000 Vdc	730	8,8 W	300
50 A	NH1G050/1000DC	1000 Vdc	920	11,0 W	300
63 A	NH1G063/1000DC	1000 Vdc	1760	13,5 W	300
80 A	NH1G080/1000DC	1000 Vdc	3160	17,0 W	300
100 A	NH1G100/1000DC	1000 Vdc	5280	21,0 W	300
125 A	NH1G125/1000DC	1000 Vdc	11340	22 W	300
160 A	NH1G160/900DC	1000 Vdc	20750	32 W	300
NH3					
160 A	NH3G160/1000DC	1000Vdc	10000	38 W	1300 NEW
200 A	NH3G200/1000DC	1000Vdc	20000	45 W	1300 NEW
250 A	NH3G250/1000DC	1000Vdc	40000	44 W	1300 NEW
315 A	NH3G315/1000DC	1000Vdc	80000	54 W	1300 NEW
350 A	NH3G350/1000DC	1000Vdc	90000	55 W	1300 NEW
400 A	NH3G400/1000DC	1000Vdc	138000	58 W	1300 NEW



FOTOVOLTAICO

Photovoltaic | Photovoltaïque

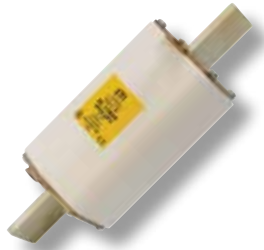
FUSIBILI NH1 - NH2 - NH3 SOLAR 1100VDC
 1100Vdc NH1-NH2-NH3 SOLAR fuses | Fusibles NH1-NH2-NH3 SOLAR

Caratteristica gPV	Characteristic gPV	Caractéristique gPV
Tensione 1100Vdc	Voltage 1100Vdc	Tension 1100Vdc
Capacità di rottura 10kAdc	Breaking capacity 10kAdc	Pouvoir de coupure 10kAdc
Norme riferimento IEC 60269 - 6 IEC 60269 - 4 UL 2579 UL 248-1	Standards IEC 60269 - 6 IEC 60269 - 4 UL 2579 UL 248-1	Normes IEC 60269 - 6 IEC 60269 - 4 UL 2579 UL 248-1

FUSIBILI NH1 - NH2 - NH3 SOLAR 1500VDC
 1500Vdc NH1-NH2-NH3 SOLAR fuses | Fusibles NH1-NH2-NH3 SOLAR 1500Vdc

Caratteristica gPV	Characteristic gPV	Caractéristique gPV
Tensione 1500Vdc	Voltage 1500Vdc	Tension 1500Vdc
Capacità di rottura 10kAdc	Breaking capacity 10kAdc	Pouvoir de coupure 10kAdc
Norme riferimento IEC 60269 - 6	Standards IEC 60269 - 6	Normes IEC 60269 - 6

pag. 84-87



Corrente nominale Rated current Courant nominal	Codice Code Code	I _t (A ² s) I _t (A ² s) I _t (A ² s)	Pot. dissipata Power loss Puissance dissipée	Peso g Weight g Poids g	
NH1XL					
• 63 A	NH1XLG063/1100DC	3520	15,0 W	750	1/16
• 80 A	NH1XLG080/1100DC	5500	17,0 W	750	1/16
• 100 A	NH1XLG100/1100DC	9000	20,0 W	750	1/16
• 125 A	NH1XLG125/1100DC	15000	23,0 W	750	1/16
• 160 A	NH1XLG160/1100DC	28640	35,0 W	750	1/16
• 200 A	NH1XLG200/1100DC	83400	32,6 W	750	1/16
NH2XL					
• 200 A	NH2XLG200/1100DC	60000	42,0 W	1050	1/15
• 250 A	NH2XLG250/1100DC	117400	46,0 W	1050	1/15
• 350 A	NH2XLG350/1100DC	130000	65,5 W	1050	1/15
NH3L					
• 200 A	NH3LG200/1100DC	59000	41,0 W	1360	1/22
• 224 A	NH3LG224/1100DC	88000	44,0 W	1360	1/22
• 250 A	NH3LG250/1100DC	115000	45,0 W	1360	1/22
• 300 A	NH3LG300/1100DC	220000	53,5 W	1360	1/22
• 315 A	NH3LG315/1100DC	221900	54,0 W	1360	1/22
• 350 A	NH3LG350/1100DC	260000	60,5 W	1360	1/22
• 400 A	NH3LG400/1100DC	345000	67,0 W	1360	1/22
• 450 A	NH3LG450/1100DC	280000	98,0 W	1360	1/22
• 500 A	NH3LG500/1100DC	370000	112,0 W	1360	1/22
• 630 A	NH3LG630/1100DC	450000	119,0 W	1360	1/22
ULNH1XL					
63 A	ULNH1XLG063/1100DC	3500	15,7 W	750	1/16
80 A	ULNH1XLG080/1100DC	5500	16,0 W	750	1/16
100 A	ULNH1XLG100/1100DC	9000	19,0 W	750	1/16
125 A	ULNH1XLG125/1100DC	15000	22,0 W	750	1/16
160 A	ULNH1XLG160/1100DC	30000	30,0 W	750	1/16
200 A	ULNH1XLG200/1100DC	80000	34,8 W	750	1/16
ULNH2XL					
200 A	ULNH2XLG200/1100DC	75000	36,0 W	1050	1/15
250 A	ULNH2XLG250/1100DC	120000	44,0 W	1050	1/15
ULNH3L					
315 A	ULNH3LG315/1100DC	230000	53,6 W	1360	1/22
350 A	ULNH3LG350/1100DC	260000	58,0 W	1360	1/22
400 A	ULNH3LG400/1100DC	350000	64,8 W	1360	1/22

 • Non omologati
Not approved
Non homologué

 A richiesta fornibile con indicatore
Available with indicator upon request
Sur demande disponible avec indicateur

 pronta
in stock
en stock

pag. 84-87



Corrente nominale Rated current Courant nominal	Codice Code Code	I _t (A ² s) I _t (A ² s) I _t (A ² s)	Pot. dissipata Power loss Puissance dissipée	Peso g Weight g Poids g	
NH1XL					
63 A	NH1XLG063/1500DC	6000	14 W	850	1/17
80 A	NH1XLG080/1500DC	15000	16 W	850	1/17
100 A	NH1XLG100/1500DC	26000	19 W	850	1/17
125 A	NH1XLG125/1500DC	37000	22 W	850	1/17
160 A	NH1XLG160/1500DC	48000	30 W	850	1/17
NH2XL					
200 A	NH2XLG200/1500DC	75000	36 W	1150	1/15
250 A	NH2XLG250/1500DC	132000	44 W	1150	1/15
NH3L					
315 A	NH3LG315/1500DC	18000	47 W	1500	1/22
350 A	NH3LG350/1500DC	20000	58 W	1500	1/22

 pronta
in stock
en stock

FOTOVOLTAICO

Photovoltaic | Photovoltaïque

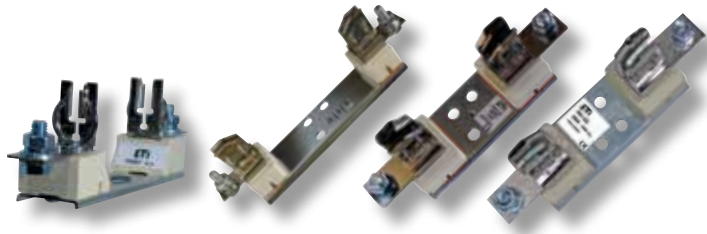

BASI UNIPOLARI NH TERMOPLASTICHE

NH Single-pole thermoplastic bases | Bases Unipolaires NH thermoplastiques

Tension	Voltage	Tension
1000 Vdc - 1200 Vdc	1000 Vdc - 1200 Vdc	1000 Vdc - 1200 Vdc
Per fusibili grandezza	For fuses (size)	Pour fusibles (taille)
NH0 - 160A	NH0 - 160A	NH0 - 160A
NH1, NH1XL - 250A	NH1 - 250A	NH1 - 250A
NH3, NH2XL - 400A	NH3, NH2XL - 400A	NH3, NH2XL - 400A
NH3L - 630A	NH3L - 630A	NH3L - 630A
Norme riferimento	Standards	Normes
IEC/EN 60269	EN 60269	EN 60269
DIN VDE 0636	DIN VDE 0636	DIN VDE 0636
DIN 43620	DIN 43620	DIN 43620
DIN 43623	DIN 43623	DIN 43623
Classe di isolamento	Insulating class	Classe d'isolation
C - VDE 0110	C - VDE 0110	C - VDE 0110
Cod. omologazione	Approval code	Code d'homologation
ETI: PK	ETI: PK	ETI: PK

pag. 86



Grandezza Size Taille	Codice Code Code	Contatti Contacts Contacts	A/V A/V A/V	Peso g Weight g Poids g	
1000Vdc					
NH0	NH0B104/1000DC	M8-M8	160 A/1000 Vdc	258 3/42	
NH1	NH1B104/1000DC	M10	250 A/1000 Vdc	598 3/90	
NH3	NH3B104/1000DC	M12	400 A/1000 Vdc	1202 3/24	NEW
*1200Vdc					
NH1XL	NH1XLB104/1200DC	M10	250 A/1200 Vdc	258 3/42	NEW
NH2XL	NH2XLB104/1200DC	M10	400 A/1200 Vdc	598 3/90	NEW
NH3L	NH3LB104/1200DC	M12	630 A/1200 Vdc	1202 3/24	NEW



pronta
in stock
en stock



* 1200Vdc A richiesta fornibile con copricontatti
* 1200Vdc Available with terminal cover upon request
* 1200Vdc Disponible sur demande avec couvercle de protection

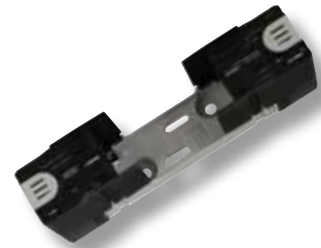

BASI UNIPOLARI NH METALLICHE

NH Single-pole metal bases | Bases Unipolaires NH métalliques

Tension	Voltage	Tension
1500 Vdc	1500 Vdc	1500 Vdc
Per fusibili grandezza	For fuses (size)	Pour fusibles (taille)
NH1XL - 250 A	NH0 - 160A	NH0 - 160A
NH2XL - 400 A	NH1 - 250A	NH1 - 250A
NH3L - 630 A	NH3, NH2XL - 400A	NH3, NH2XL - 400A
Norme riferimento	Standards	Normes
IEC/EN 60269	EN 60269	EN 60269
DIN VDE 0636	DIN VDE 0636	DIN VDE 0636
DIN 43620	DIN 43620	DIN 43620
DIN 43623	DIN 43623	DIN 43623
Classe di isolamento	Insulating class	Classe d'isolation
C - VDE 0110	C - VDE 0110	C - VDE 0110
Cod. omologazione	Approval code	Code d'homologation
ETI: U	ETI: U	ETI: PK

pag. 86



Grandezza Size Taille	Codice Code Code	Contatti Contacts Contacts	A/V A/V A/V	Peso g Weight g Poids g	
1500Vdc					
NH1XL	NH1XLB104/1500DC	M10	250 A/1500 Vdc	600 1	
NH2XL	NH2XLB104/1500DC	M10	400 A/1500 Vdc	600 1	
NH3L	NH3LB104/1500DC	M12	630 A/1500 Vdc	1000 1	



pronta
in stock
en stock



* A richiesta fornibile con copricontatti
* Available with terminal cover upon request
* Disponible sur demande avec couvercle de protection

FOTOVOLTAICO

Photovoltaic | Photovoltaïque



BASE PORTAFUSIBILI CLASSE R 600V

600V Class R Fuse Block | Base porte-fusibles Classe R 600V

Tension

600 V

Per fusibili

Classe R

Fissaggio

Bullone e guida DIN
(30A/60A)

Materiale

Termoplastico UL94 V0

Norme riferimento

UL E14853-IZLT
CSA 47235-6225-01

Cod. omologazione

Bussmann: RM600

Voltage

600 V

For fuses

Class R

Mounting

DIN rail and bolt
(30A/60A)

Material

Thermoplastic UL94 V0

Standards

UL E14853-IZLT
CSA 47235-6225-01

Approval code

Bussmann: RM600

Tension

600 V

Pour fusibles

Classe R

Fixation

Boulon et Rail DIN
(30A/60A)

Matériau

Thermoplastique UL94 V0

Normes

UL E14853-IZLT
CSA 47235-6225-01

Code d'homologation

Bussmann: RM600

pag. 86



Corrente nominale Rated current Courant nominal	Codice Code Code	Capacità di rottura Breaking capacity Pouvoir de coupure	Pot. dissipata Power loss Puissance dissipée	Dimensioni mm Dimension mm	
				A	B
20 A	ULPVS-R-20/DC	20kAdc (200kAac)	4,0 W	127,0	20,6
25 A	ULPVS-R-25/DC	20kAdc (200kAac)	4,0 W	127,0	20,6
30 A	ULPVS-R-30/DC	20kAdc (200kAac)	4,0 W	127,0	20,6
35 A	ULPVS-R-35/DC	20kAdc (200kAac)	8,8 W	139,7	27,0
40 A	ULPVS-R-40/DC	20kAdc (200kAac)	8,8 W	139,7	27,0
50 A	ULPVS-R-50/DC	20kAdc (200kAac)	8,8 W	139,7	27,0
60 A	ULPVS-R-60/DC	20kAdc (200kAac)	8,8 W	139,7	27,0
70 A	ULPVS-R-70/DC	10kAdc (200kAac)	13,6 W	200,0	34,0
80 A	ULPVS-R-80/DC	10kAdc (200kAac)	13,6 W	200,0	34,0
90 A	ULPVS-R-90/DC	10kAdc (200kAac)	13,6 W	200,0	34,0
100 A	ULPVS-R-100/DC	10kAdc (200kAac)	13,6 W	200,0	34,0
125 A	ULPVS-R-125/DC	10kAdc (200kAac)	28,5 W	244,5	46,7
150 A	ULPVS-R-150/DC	10kAdc (200kAac)	28,5 W	244,5	46,7
175 A	ULPVS-R-175/DC	10kAdc (200kAac)	28,5 W	244,5	46,7
200 A	ULPVS-R-200/DC	10kAdc (200kAac)	28,5 W	244,5	46,7

20A÷60A = 10 pz
20A÷60A = 10 pcs
20A÷60A = 10 pces

70A÷200A = 1 pz
70A÷200A = 1 pc
70A÷200A = 1 pce

pronta
in stock
en stock

pag. 85



Corrente nominale Rated current Courant nominal	N°Poli N°Pôles	Codice Code Code	Contatti Contacts Contacts	Tipi cavi Wire range Type des fils
30 A	1	ULRM60030-1SR	Vite screw vis	6-14 Cu ONLY
	2	ULRM60030-2SR	Vite screw vis	2-14 Cu #2-12 Al
	3	ULRM60030-3SR	Vite screw vis	10-18 Cu ONLY
60 A	1	ULRM60060-1CR	Morsetto box lug bornier	2-14 Cu, #2-8 Al
	2	ULRM60060-2CR	Morsetto box lug bornier	2-14 Cu, #2-8 Al
	3	ULRM60060-3CR	Morsetto box lug bornier	2-14 Cu, #2-8 Al
100 A	1	ULRM60100-1CR	Morsetto box lug bornier	1/0-8 Cu/Al
	2	ULRM60100-2CR	Morsetto box lug bornier	1/0-8 Cu/Al
	3	ULRM60100-3CR	Morsetto box lug bornier	1/0-8 Cu/Al
200 A	1	ULRM60200-1CR	Morsetto box lug bornier	250MCM-1AWG
	2	ULRM60200-2CR	Morsetto box lug bornier	2-6 AWG; Cu 2-6 AWG
	3	ULRM60200-3CR	Morsetto box lug bornier	bornier

1 pz
1 pc
1 pce

pronta
in stock
en stock

FUSIBILI PER BATTERIE

Fuses for batteries | Fusibles pour batteries



FUSIBILI 10X38 PER BATTERIE 550VDC

Fuses 10x38 for batteries 550VDC | Fusibles 10x38 pour batteries 550VDC

Tensione 550 Vdc	Voltage 550 Vdc	Tension 550 Vdc
Corpo Ceramica	Body Ceramic	Corps Céramique
Capacità di rottura 30kAdc	Breaking capacity 30kAdc	Pouvoir de coupure 30kAdc
Norme riferimento IEC 60269	Standards IEC 60269	Normes IEC 60269



Corrente nominale Rated current Courant nominal	Codice Code Code	I ² t (A ² s) I ² t (A ² s) I ² t (A ² s)	Pot. dissipata Power loss Puissance dissipée	Peso g Weight g Poids g
2 A	CH138220/550BT	1,8	1,12	10/12
4 A	CH138240/550BT	7,8	1,25	10/12
6 A	CH138260/550BT	27,3	1,75	10/12
8 A	CH138280/550BT	53,4	1,9	10/12
10 A	CH138310/550BT	18,8	2,4	10/12
12 A	CH138312/550BT	41,5	1,9	10/12
16 A	CH138316/550BT	88	2,6	10/12
20 A	CH138320/550BT	166	3,2	10/12
25 A	CH138325/550BT	270	4,1	10/12

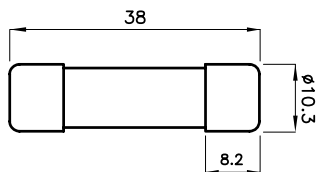

10/500 pz
 10/500 pcs
 10/500 pces
 pronta in stock
 en stock
 Disponibili anche in versione SU
 Bolt contacts upon request
 Disponibles également dans la version SU



FUSIBILI 10X38 PER BATTERIE 800VDC

Fuses 10x38 for batteries 800VDC | Fusibles 10x38 pour batteries 800VDC

Tensione 800 Vdc	Voltage 800 Vdc	Tension 800 Vdc
Corpo Ceramica	Body Ceramic	Corps Céramique
Capacità di rottura 30kAdc	Breaking capacity 30kAdc	Pouvoir de coupure 30kAdc
Norme riferimento IEC 60269	Standards IEC 60269	Normes IEC 60269



Corrente nominale Rated current Courant nominal	Codice Code Code	I ² t (A ² s) I ² t (A ² s) I ² t (A ² s)	Pot. dissipata Power loss Puissance dissipée	Peso g Weight g Poids g
2 A	CH138220/800BT	1,6	1,12	10/12
4 A	CH138240/800BT	8,9	1,25	10/12
6 A	CH138260/800BT	27,2	1,75	10/12
8 A	CH138280/800BT	65,8	1,9	10/12
10 A	CH138310/800BT	26,6	2,4	10/12
12 A	CH138312/800BT	54,6	1,9	10/12
16 A	CH138316/800BT	109,3	2,6	10/12

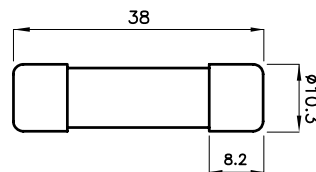

10/500 pz
 10/500 pcs
 10/500 pces
 pronta in stock
 en stock
 Disponibili anche in versione SU
 Bolt contacts upon request
 Disponibles également dans la version SU

FUSIBILI PER BATTERIE

Fuses for batteries | Fusibles pour batteries



FUSIBILI 14X51 PER BATTERIE 800VDC

Fuses 14x51 for batteries 800VDC | Fusibles 14x51 pour batteries 800VDC

Tensione 800 Vdc	Voltage 800 Vdc	Tension 800 Vdc
Corpo Ceramica	Body Ceramic	Corps Céramique
Capacità di rottura 30kAdc	Breaking capacity 30kAdc	Pouvoir de coupure 30kAdc
Norme riferimento IEC 60269	Standards IEC 60269	Normes IEC 60269



Corrente nominale Rated current Courant nominal	Codice Code Code	I ² t (A ² s) I ² t (A ² s)	Pot. dissipata Power loss Puissance dissipée	Peso g Weight g Poids g
16 A	CH151316/800BT	136	3,1	19/21
20 A	CH151320/800BT	284	3,2	19/21
25 A	CH151325/800BT	438	4	19/21
32 A	CH151332/800BT	1050	5,1	19/21
36 A	CH151336/800BT	1160	5,6	19/21

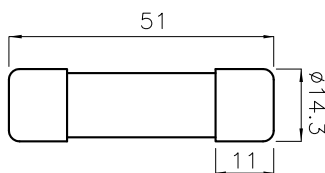

10/200 pz
10/200 pcs
10/200 pces



pronta
in stock
en stock



Disponibili anche in versione SU
Bolt contacts upon request
Disponibles également dans la version SU

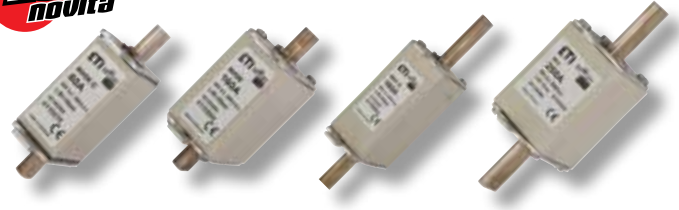

FUSIBILI NH PER BATTERIE 80VDC

NH fuses for batteries 80VDC | Fusibles NH pour batteries 80VDC

Tensione 80 Vdc	Voltage 80 Vdc	Tension 80 Vdc
Corpo Ceramica	Body Ceramic	Corps Céramique
Capacità di rottura 50kAdc	Breaking capacity 50kAdc	Pouvoir de coupure 50kAdc
Norme riferimento IEC 60269	Standards IEC 60269	Normes IEC 60269



pag. 79-80



Corrente nominale Rated current Courant nominal	Codice Code Code	Pot. dissipata Power loss Puissance dissipée	Peso g Weight g Poids g	
---	------------------------	--	-------------------------------	--

NH00C				
20 A	NH000BT020/80DC	4,6	125	3/120
25 A	NH000BT025/80DC	5,8	125	3/120
32 A	NH000BT032/80DC	6,6	125	3/120
40 A	NH000BT040/80DC	9,4	125	3/120
50 A	NH000BT050/80DC	11,1	125	3/120

NH00				
63 A	NH00BT063/80DC	11,7	173	3/90
80 A	NH00BT080/80DC	10,4	173	3/90
100 A	NH00BT100/80DC	11,1	173	3/90
125 A	NH00BT125/80DC	13,4	173	3/90
160 A	NH00BT160/80DC	15,5	173	3/90

NH1C				
20 A	NH01BT020/80DC	6,3	233	3/45
25 A	NH01BT025/80DC	7,3	233	3/45
32 A	NH01BT032/80DC	9	233	3/45
40 A	NH01BT040/80DC	11,2	233	3/45
50 A	NH01BT050/80DC	14,5	233	3/45
63 A	NH01BT063/80DC	16,8	233	3/45
80 A	NH01BT080/80DC	11,4	233	3/45
100 A	NH01BT100/80DC	12	233	3/45
125 A	NH01BT125/80DC	14,8	233	3/45
160 A	NH01BT160/80DC	17,6	233	3/45

NH1				
200 A	NH1BT200/80DC	26,6	430	3/24
250 A	NH1BT250/80DC	31	430	3/24

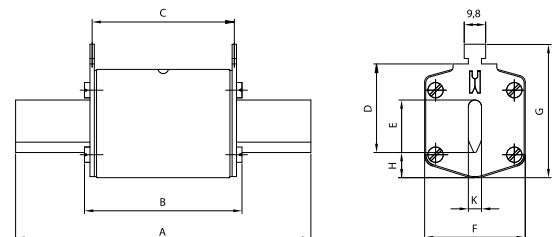

	A	B	C	E	G	S	L	N	P	R	T
1	135	24	40	46	52	6	65	73	20,5	13,7	27,5
2	150	30	48	54	61	6	65	73	27,3	16,2	27,5
3	150	37	60	64	74	6	65	73	35,6	17	27,5



pronta
in stock
en stock



30 giorni
30 days
30 jours

FUSIBILI PER BATTERIE

Fuses for batteries | Fusibles pour batteries



FUSIBILI NH PER BATTERIE 440VDC NH fuses for batteries 440VDC | Fusibles NH pour batteries 440VDC

Tensione 440 Vdc	Voltage 440 Vdc	Tension 440 Vdc
Corpo Ceramica	Body Ceramic	Corps Céramique
Capacità di rottura 30kAdc	Breaking capacity 30kAdc	Pouvoir de coupure 30kAdc
Norme riferimento IEC 60269	Standards IEC 60269	Normes IEC 60269



Corrente nominale Rated current Courant nominal	Codice Code Code	Pot. dissipata Power loss Puissance dissipée	Peso g Weight g Poids g
20 A	NH1BT020/440DC	6,3	233
25 A	NH1BT025/440DC	7,3	233
32 A	NH1BT032/440DC	9,0	233
40 A	NH1BT040/440DC	11,2	233
50 A	NH1BT050/440DC	14,5	233
63 A	NH1BT063/440DC	16,8	233
80 A	NH1BT080/440DC	11,4	233
100 A	NH1BT100/440DC	12,0	233
125 A	NH1BT125/440DC	14,8	233
160 A	NH1BT160/440DC	17,6	233

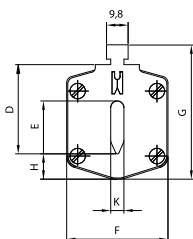
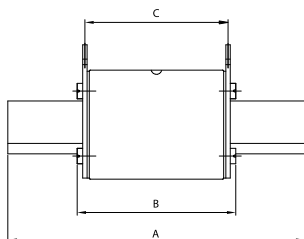

	A	B	C	D	E	F	G	H	K
1C	135	68	65	40	15	28	61	12	6

3/45 pz
 3/45 pcs
 3/45 pces
 30 giorni
 30 days
 30 jours



FUSIBILI NH PER BATTERIE 550VDC NH fuses for batteries 550VDC | Fusibles NH pour batteries 550VDC

Tensione 550 Vdc	Voltage 550 Vdc	Tension 550 Vdc
Corpo Ceramica	Body Ceramic	Corps Céramique
Capacità di rottura 30kAdc	Breaking capacity 30kAdc	Pouvoir de coupure 30kAdc
Norme riferimento IEC 60269	Standards IEC 60269	Normes IEC 60269

Corrente nominale Rated current Courant nominal	Codice Code Code	Pot. dissipata Power loss Puissance dissipée	Peso g Weight g Poids g
NH1			
40 A	NH1BT040/550DC	6	420
50 A	NH1BT050/550DC	7	420
63 A	NH1BT063/550DC	9	420
80 A	NH1BT080/550DC	12	420
100 A	NH1BT100/550DC	15	420
125 A	NH1BT125/550DC	20	420
160 A	NH1BT160/550DC	26	420
200 A	NH1BT200/550DC	32	420
224 A	NH1BT224/550DC	37	420
250 A	NH1BT250/550DC	43	420
NH2			
125 A	NH2BT125/550DC	20	660
160 A	NH2BT160/550DC	26	660
200 A	NH2BT200/550DC	32	660
224 A	NH2BT224/550DC	37	660
250 A	NH2BT250/550DC	43	660
315 A	NH2BT315/550DC	57	660
350 A	NH2BT350/550DC	67	660
400 A	NH2BT400/550DC	76	660
NH3			
250 A	NH3BT250/550DC	43	870
315 A	NH3BT315/550DC	57	870
350 A	NH3BT350/550DC	67	870
400 A	NH3BT400/550DC	76	870
425 A	NH3BT425/550DC	84	870
500 A	NH3BT500/550DC	110	870
630 A	NH3BT630/550DC	160	870

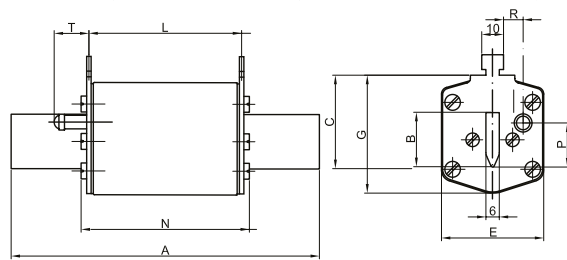

	A	B	C	E	G	S	L	N	P	R	T
1	135	24	40	46	52	6	65	73	20,5	13,7	27,5
2	150	30	48	54	61	6	65	73	27,3	16,2	27,5
3	150	37	60	64	74	6	65	73	35,6	17	27,5

3/24 pz
 3/24 pcs
 3/24 pces
 30 giorni
 30 days
 30 jours
 Disponibile anche striker e a fissaggio a bullone
 Striker and bolt contacts upon request
 Percuteur et fixation à boulon également disponibles sur demande

FUSIBILI PER BATTERIE

Fuses for batteries | Fusibles pour batteries



FUSIBILI NH PER BATTERIE 700VDC NH fuses for batteries 700VDC | Fusibles NH pour batteries 700VDC

Tensione 700 Vdc	Voltage 700 Vdc	Tension 700 Vdc
Corpo Ceramica	Body Ceramic	Corps Céramique
Capacità di rottura 30kAdc	Breaking capacity 30kAdc	Pouvoir de coupure 30kAdc
Norme riferimento IEC 60269	Standards IEC 60269	Normes IEC 60269



Corrente nominale Rated current Courant nominal	Codice Code Code	Pot. dissipata Power loss Puissance dissipée	Peso g Weight g Poids g
NH1			
40 A	NH1BT040/700DC	6	420
50 A	NH1BT050/700DC	7	420
63 A	NH1BT063/700DC	9	420
80 A	NH1BT080/700DC	12	420
100 A	NH1BT100/700DC	15	420
125 A	NH1BT125/700DC	20	420
160 A	NH1BT160/700DC	26	420
200 A	NH1BT200/700DC	32	420
224 A	NH1BT224/700DC	37	420
250 A	NH1BT250/700DC	43	420
NH2			
125 A	NH2BT125/700DC	20	660
160 A	NH2BT160/700DC	26	660
200 A	NH2BT200/700DC	32	660
224 A	NH2BT224/700DC	37	660
250 A	NH2BT250/700DC	43	660
315 A	NH2BT315/700DC	57	660
350 A	NH2BT350/700DC	67	660
400 A	NH2BT400/700DC	76	660
NH3			
250 A	NH3BT250/700DC	43	870
315 A	NH3BT315/700DC	57	870
350 A	NH3BT350/700DC	67	870
400 A	NH3BT400/700DC	76	870
425 A	NH3BT425/700DC	84	870
500 A	NH3BT500/700DC	110	870
630 A	NH3BT630/700DC	160	870

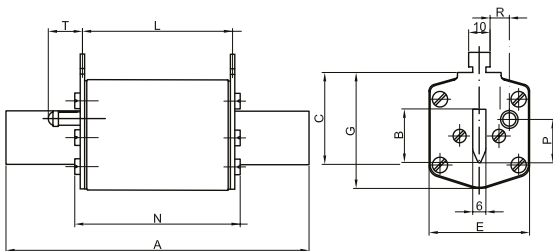

	A	B	C	E	G	S	L	N	P	R	T
1	135	24	40	46	52	6	65	73	20,5	13,7	27,5
2	150	30	48	54	61	6	65	73	27,3	16,2	27,5
3	150	37	60	64	74	6	65	73	35,6	17	27,5



3/24 pz
3/24 pcs
3/24 pces



30 giorni
30 days
30 jours



Disponibile anche striker
e a fissaggio a bullone
Striker and bolt contacts upon request
Percuteur et fixation à boulon également
disponibles sur demande



FUSIBILI NH PER BATTERIE 800VDC NH fuses for batteries 800VDC | Fusibles NH pour batteries 800VDC

Tensione 800 Vdc	Voltage 800 Vdc	Tension 800 Vdc
Corpo Ceramica	Body Ceramic	Corps Céramique
Capacità di rottura 30kAdc	Breaking capacity 30kAdc	Pouvoir de coupure 30kAdc
Norme riferimento IEC 60269	Standards IEC 60269	Normes IEC 60269



pag. 79-80



Corrente nominale Rated current Courant nominal	Codice Code Code	Pot. dissipata Power loss Puissance dissipée	Peso g Weight g Poids g
NH1			
40 A	NH1BT040/800DC	6	420
50 A	NH1BT050/800DC	7	420
63 A	NH1BT063/800DC	9	420
80 A	NH1BT080/800DC	12	420
100 A	NH1BT100/800DC	15	420
125 A	NH1BT125/800DC	20	420
160 A	NH1BT160/800DC	26	420
200 A	NH1BT200/800DC	32	420
NH2			
125 A	NH2BT125/800DC	20	660
160 A	NH2BT160/800DC	26	660
200 A	NH2BT200/800DC	32	660
224 A	NH2BT224/800DC	37	660
250 A	NH2BT250/800DC	43	660
315 A	NH2BT315/800DC	57	660
350 A	NH2BT350/800DC	67	660
400 A	NH2BT400/800DC	76	660

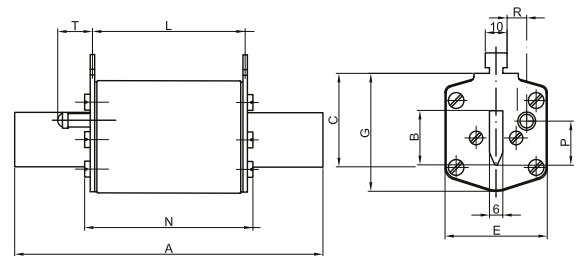

	A	B	C	E	G	S	L	N	P	R	T
1	135	24	40	46	52	6	65	73	20,5	13,7	27,5
2	150	30	48	54	61	6	65	73	27,3	16,2	27,5
3	150	37	60	64	74	6	65	73	35,6	17	27,5



3/24 pz
3/24 pcs
3/24 pces



30 giorni
30 days
30 jours



Disponibile anche striker
e a fissaggio a bullone
Striker and bolt contacts upon request
Percuteur et fixation à boulon également
disponibles sur demande

DIMENSIONI

Dimensions | *Dimensions*

FUSIBILI 10X38 PV SOLAR 10x38 PV SOLAR fuses | *Fusibles 10X38 PV SOLAR*

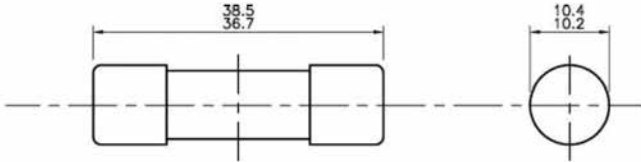

FUSIBILI PVS-R SOLAR PVS-R SOLAR fuses | *Fusibles PVS-R SOLAR*

Dimensions - in (mm)

Amp Range	A	B
20-30	5.0 (127.0)	0.81 (20.6)
35-60	5.5 (139.7)	1.06 (27.0)
70-100	7.88 (200.0)	1.34 (34.0)
125-200	9.63 (244.5)	1.84 (46.7)

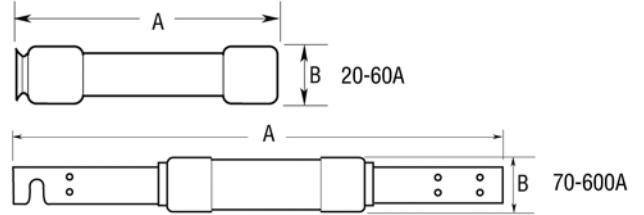

FUSIBILI NHO SOLAR 750VDC-1000VDC 750Vdc-1000Vdc NHO SOLAR fuses | *Fusibles NHO SOLAR 750Vdc-1000Vdc*

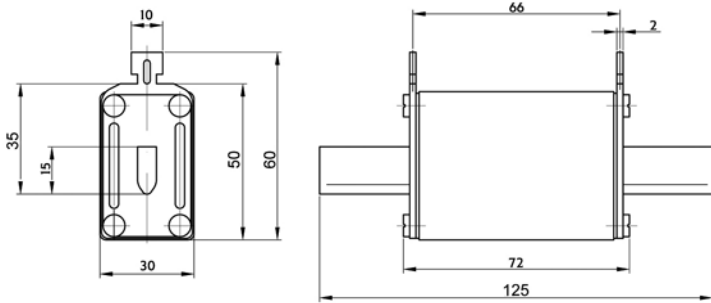

FUSIBILI NH1 SOLAR 750VDC-1000VDC 750Vdc-1000Vdc NH1 SOLAR fuses | *Fusibles NH1 SOLAR 750Vdc-1000Vdc*

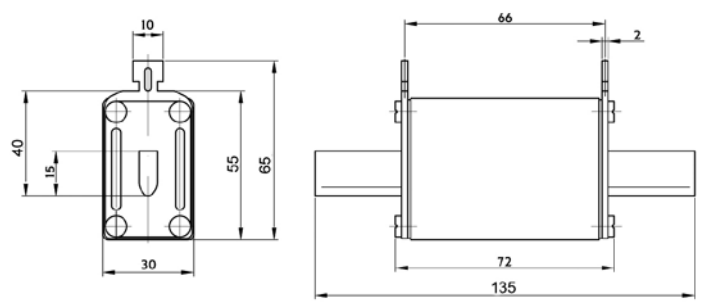

FUSIBILI NH1 SOLAR 1100VDC 1100Vdc NH1 SOLAR fuses | *Fusibles NH1 SOLAR 1100Vdc*

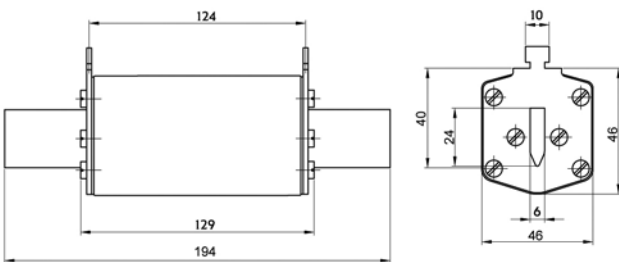

FUSIBILI NH2 - NH3 SOLAR 1100VDC 1100Vdc NH2 - NH3 SOLAR fuses | *Fusibles NH2 - NH3 SOLAR 1100Vdc*

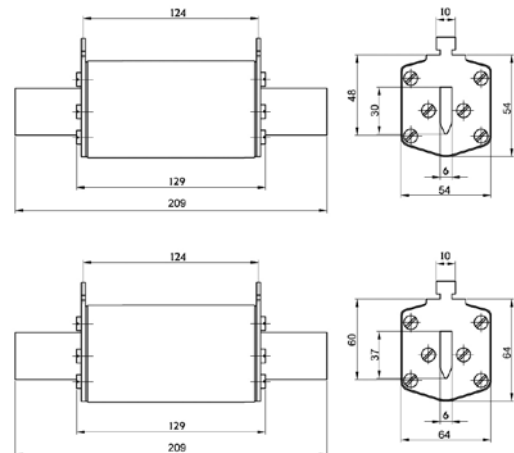

DIMENSIONI

Dimensions | *Dimensions*

FUSIBILI NH1 - NH2 - NH3 SOLAR 1500VDC

1500Vdc NH1-NH2-NH3 SOLAR fuses | *Fusibles NH1-NH2-NH3 SOLAR 1500Vdc*

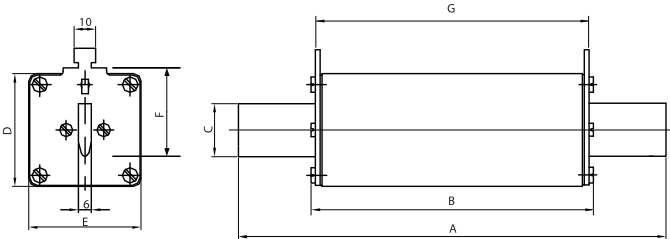

PORTAFUSIBILI CON CASSETTO ESTRAIBILE 10X38 1000VDC

1000Vdc Fuseblock with removable drawer | *Porte-fusibles avec tiroir amovibile 1000Vdc*

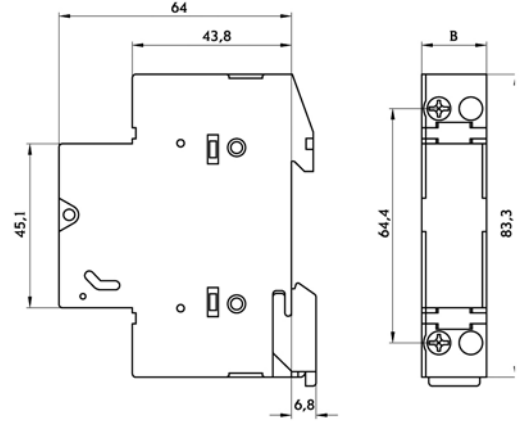

BASI UNIPOLARI NH METALLICHE 1000VDC

1000Vdc NH Single-pole metal bases | *Bases Unipolaires NH métalliques 1000Vdc*

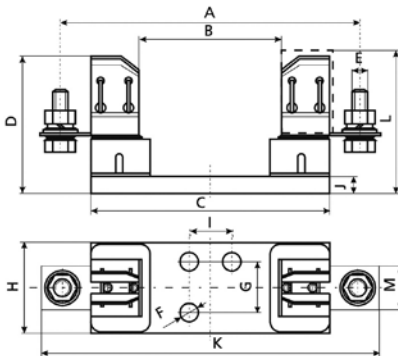

CODICE CODE CODE	Dimensions [mm]											
	A	B	C	D	E	F	G	H	I	J	K	M
NH1B104/1000DC	175	80	141	81	M10	Ø10,5	30	55	25	10	200	26
NH0B104/1000DC	150	74	130	60	M8-M8	Ø7,5	-	33	25	4,5	170	20

PORTAFUSIBILI 14X51

14x51 fuseblock | *Porte-fusibles 14X51*

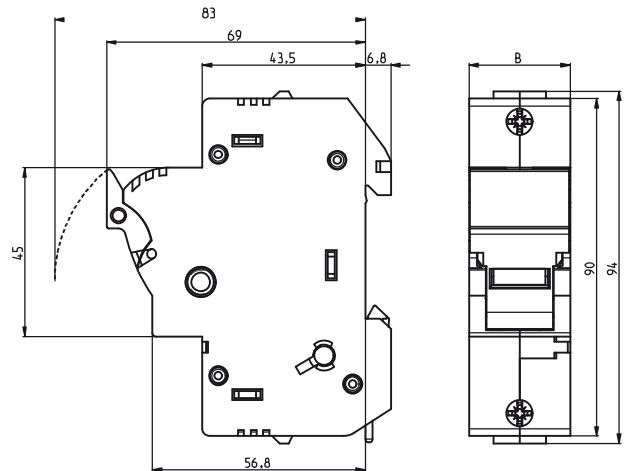

BASE PORTAFUSIBILI CLASSE R 600V

600V Class R Fuse Block | *Base porte-fusibles Classe R 600V*

Dimensions - in 600V, 1 to 30A

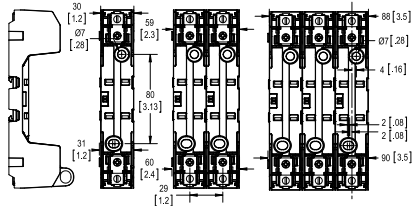

600V, 31 to 60A

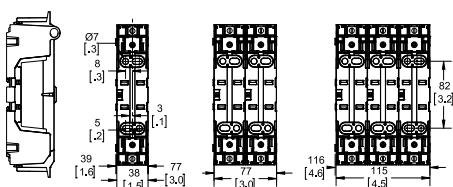

600V, 70 to 100A

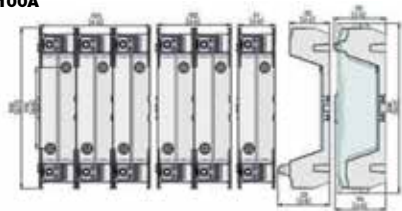

600V, 110 to 200A

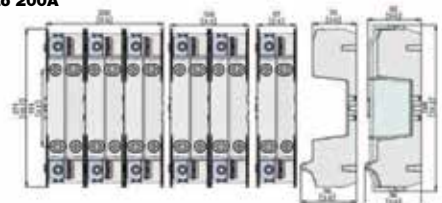

CARATTERISTICHE

Characteristic | *Caractéristiques*

BASI UNIPOLARI NH METALLICHE 1200VDC 1200Vdc NH Single-pole metal bases | *Bases Unipolaires NH métalliques 1200Vdc*

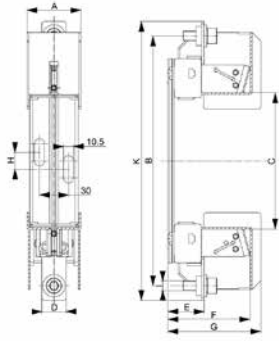

CODICE
CODE
CODE

	Dimensions [mm]									
	A	B	C	D	E	F	G	H	I	K
NH1B104/1200DC	56	257	140	25	37	84,5	96	17,5	M10	287
NH2B104/1200DC	64	257	140	30	37	100	103	17,5	M10	287
NH3B104/1200DC	68	270	140	40	38	103	-	25	M12	307

FUSIBILI 10X38 PV SOLAR 10x38 PV SOLAR fuses | *Fusibles 10X38 PV SOLAR*

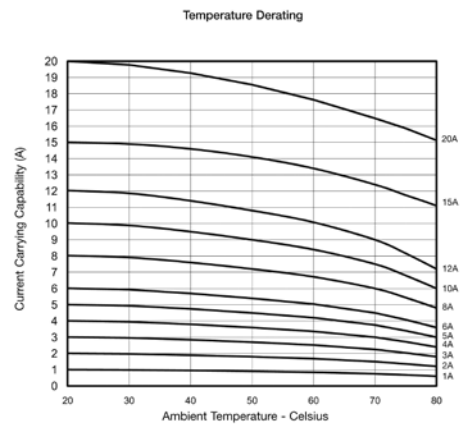
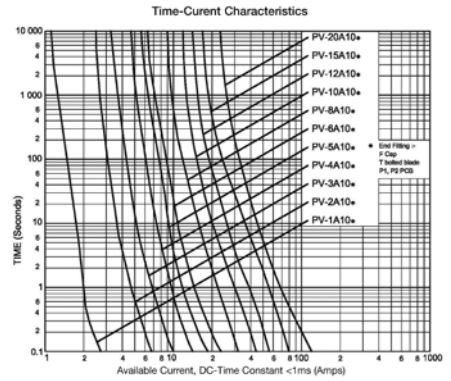

FUSIBILI PVS-R SOLAR PVS-R SOLAR fuses | *Fusibles PVS-R SOLAR*

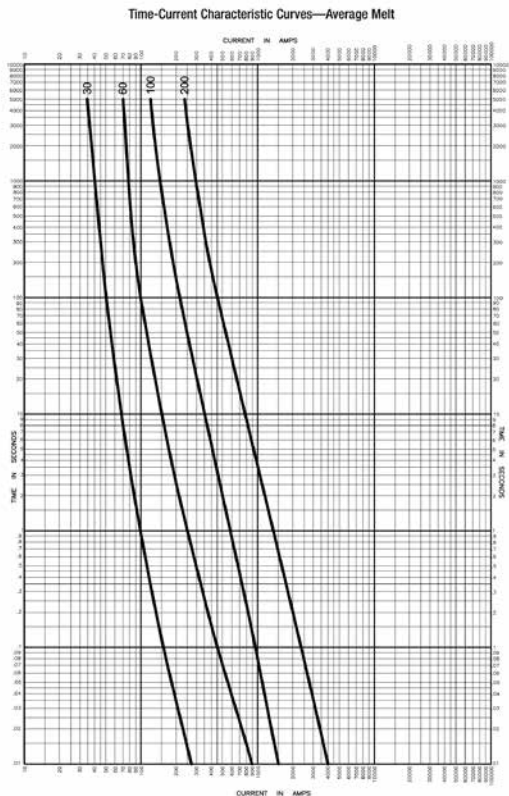

FUSIBILI NH 750VDC-1000VDC 750Vdc-1000Vdc NH0 SOLAR fuses | *Fusibles NH0 SOLAR 750Vdc-1000Vdc*

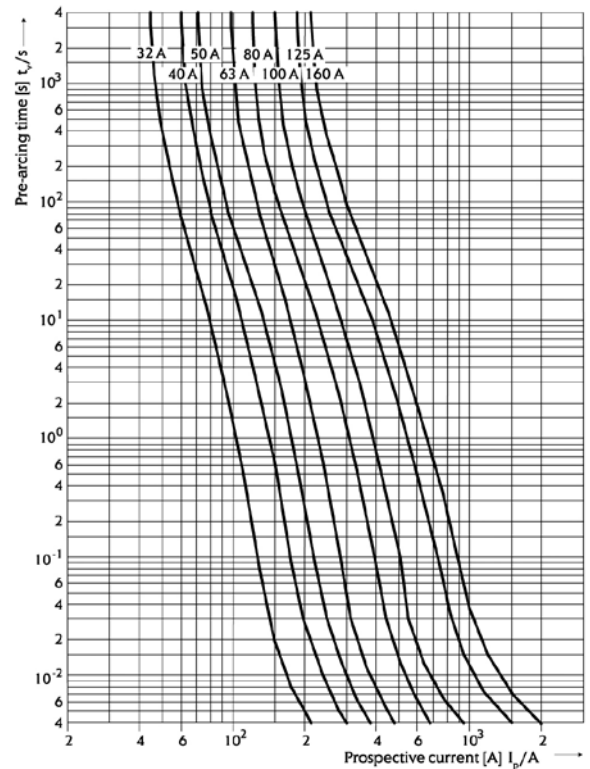

gPV 750V, 1000V t-I characteristics

CARATTERISTICHE

Characteristic | *Caractéristiques*

FUSIBILI NH1-NH2-NH3 1100VDC

1100Vdc NH1-NH2-NH3 fuses | *Fusibles NH1-NH2-NH3 1100Vdc*

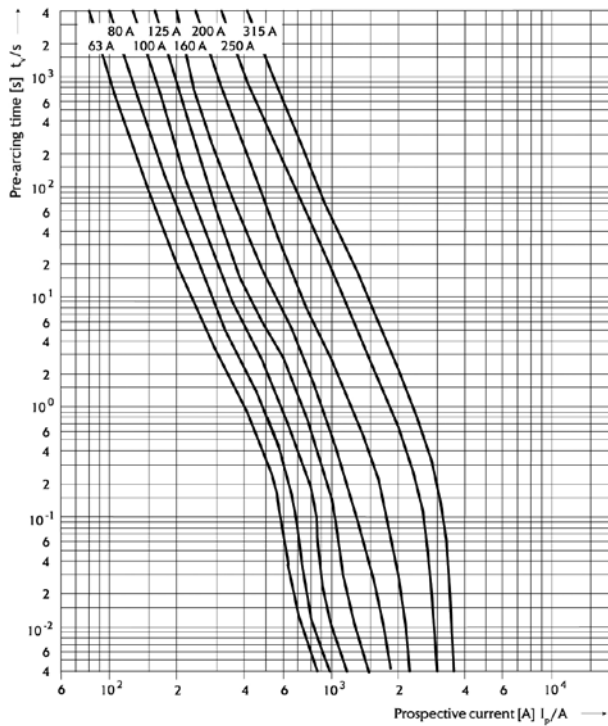

FUSIBILI NH1 - NH2 - NH3 SOLAR 1500VDC

1500Vdc NH1-NH2-NH3 SOLAR fuses | *Fusibles NH1-NH2-NH3 SOLAR 1500Vdc*

